



Republic of the Philippines
DEPARTMENT OF ENERGY
(Kagawaran ng Enerhiya)

BIDS AND AWARDS COMMITTEE

Bid Bulletin No. 1 for 13th Public Bidding CY 2021

PROCUREMENT FOR THE SUPPLY, DELIVERY INSTALLATION AND COMMISSIONING OF VARIOUS LOTS OF AIRCONDITIONING SYSTEM FOR FIELD OFFICES UNDER THE ALTERNATIVE FUEL AND ENERGY TECHNOLOGY DIVISION'S LOCALLY FUNDED PROJECT

- Please refer to the attached **Annex “A”, “B” and “C”** for the Proposed Air-condition Installations as indicated

Considering the COVID-19 situation, Opening of Bids can be witnessed through video conferencing via MS Teams platform. In preparation, you may download the app in advance to witness the proceedings. Bidders and observers may submit their intent to participate with the following information such as the nominated email address to ideogracias@doe.gov.ph

This Bid Bulletin forms part of the terms of reference. All other terms and conditions in the Bid Documents issued by the DOE-BAC not consistent with this Supplemental / Bid Bulletin shall remain valid and effective.

Approved for Issuance:

USEC. ROBERTO B. UY
Chairperson, Bids and Awards Committee

FGD/jjad

Annex A - LFO PROPOSED INSTALLATION OF AIR CONDITIONING UNITS

Area	Capacity/Type of ACU	No. of Unit/s	Type of Installation	Type of Material where the units are fixed
2nd Floor				
Pantry Room	1 HP Split	1	Wall Mounted	Concrete wall
OD File Room	1 HP Split	1	Wall Mounted	Concrete wall
VIP Lounge	1 HP Split	1	Wall Mounted	Concrete wall
Electrical Room	1 HP Split	1	Wall mounted	Concrete wall
Office Supply Room	1 HP Split	1	Wall mounted	Concrete wall
Ground Floor				
EIMD Supply Room	1 HP Split	1	Wall mounted	Concrete wall
ERDUD Supply Room	1 HP Split	1	Wall mounted	Concrete wall
EIMD File Room	1 HP Split	1	Wall mounted	Concrete wall
EIMD Equipment Room	1 HP Split	1	Wall Mounted	Concrete wall
ERDUD Equipment Room	1 HP Split	1	Wall Mounted	Concrete wall
Electrical Room	1 HP Split	1	Wall mounted	Concrete wall
Pantry Room	1 HP Split	1	Wall mounted	Concrete wall
Annex Building				
Mini Laboratory Room	1 HP Split	1	Wall Mounted	Concrete wall
Laboratory Room	1 HP Split	2	Wall Mounted	Concrete wall
Testing Facility	1 HP Split	2	Wall mounted	Concrete wall

Luzon Field Office -Aircon Plan Layout: Ground Floor

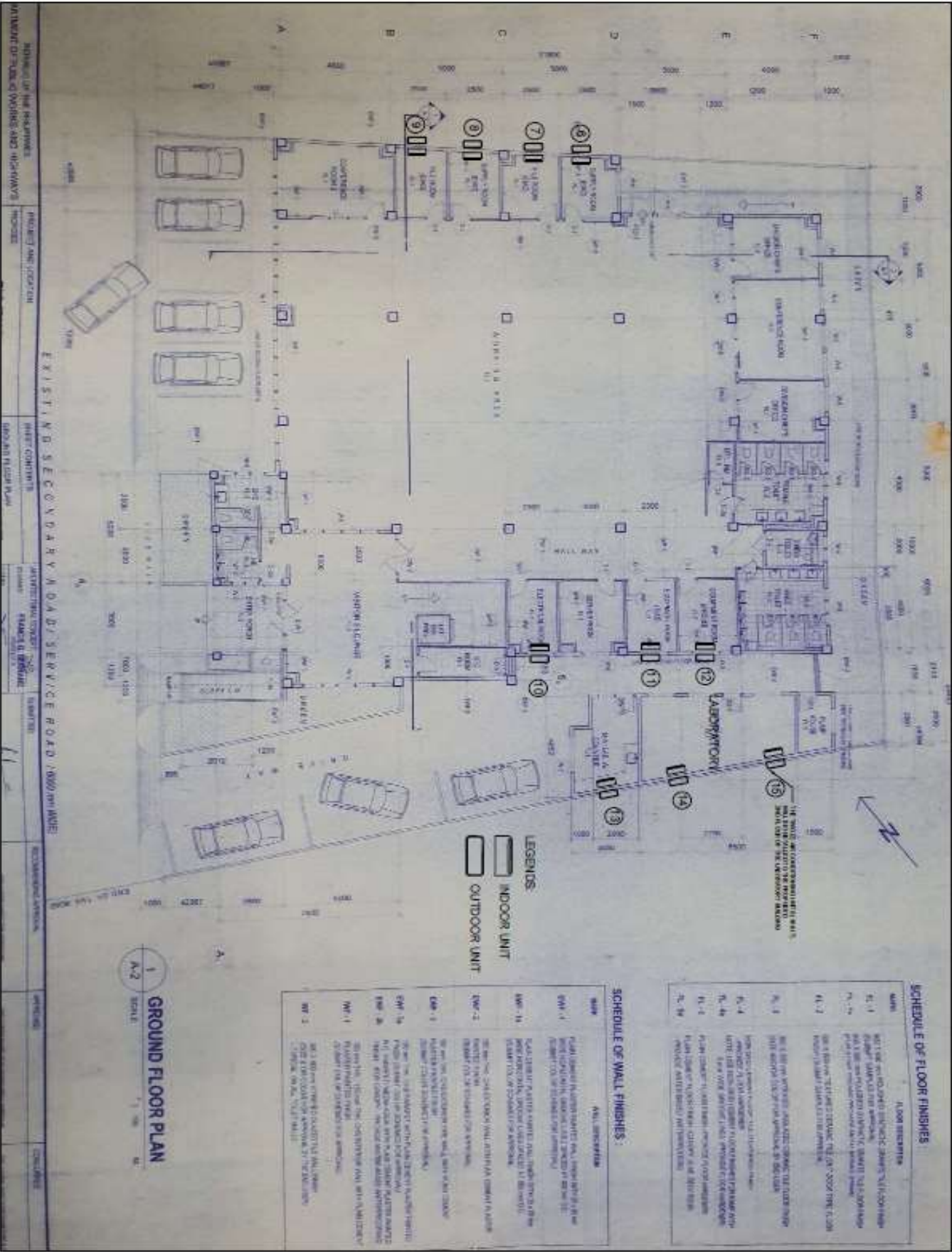

Luzon Field Office -Aircon Plan Layout: Second Floor

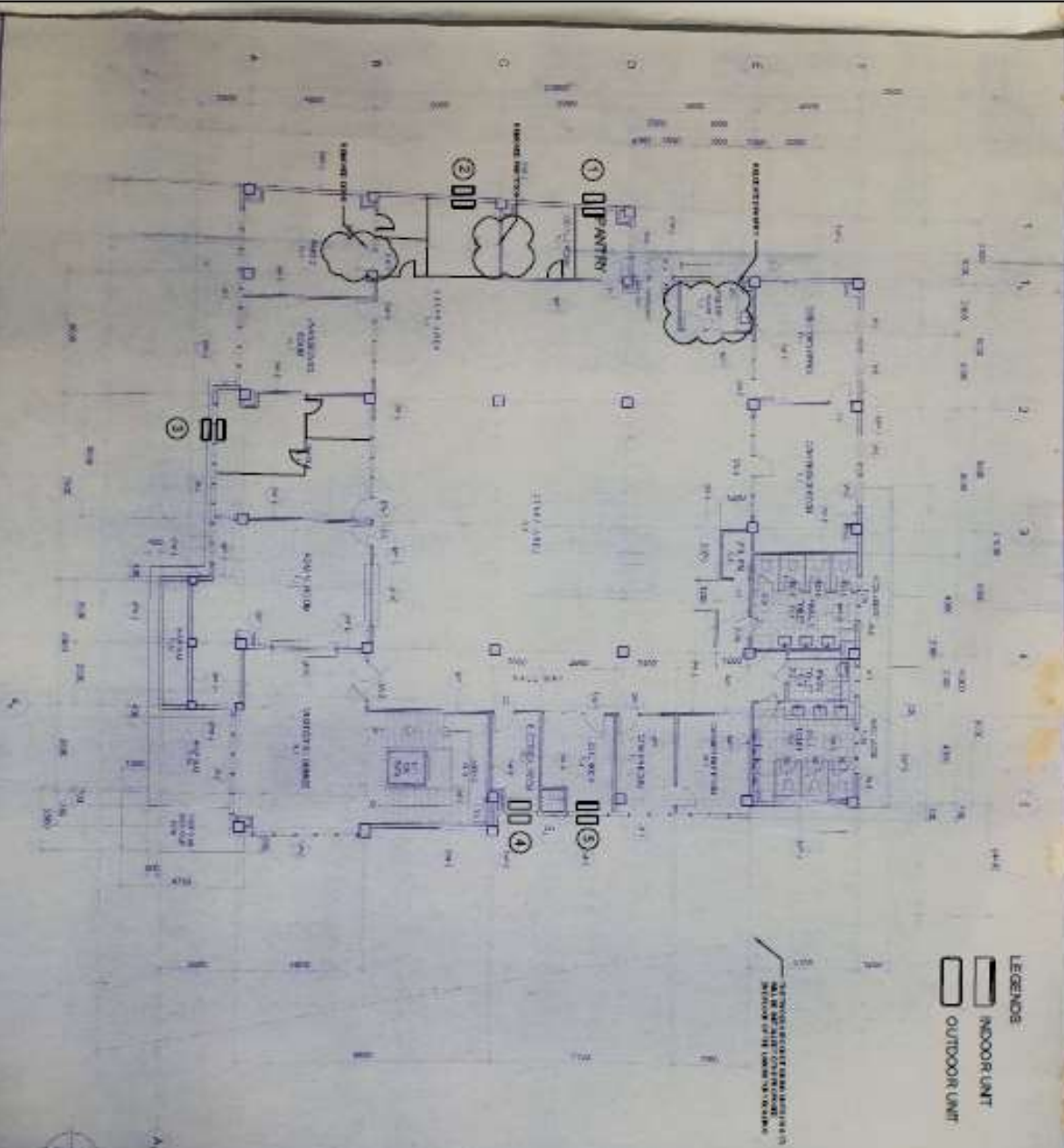

SECOND FLOOR PLAN

[illegible][illegible]

Annex B - VFO PROPOSED INSTALLATION FOR AIR CONDITIONING UNITS

Area	Capacity/Type of ACU	No. of Unit	Type of installation	Type of Material Where the units are fixed
3rd Floor				
Conference room	5 TR Floor mounted	1	Floor mounted	Floor mounting bracket
IT room	3 Hp Split	1	Wall mounted	Concrete wall
Drafting/Supply room	3 Hp Split	1	Wall mounted	Concrete wall
Workstation Area 1- ERDUD	3Hp Split	1	Wall mounted	Concrete wall
Workstation Area 2- ERDUD	3Hp Split	1	Wall mounted	Concrete wall
Workstation Area 3- ERDUD	5Hp Floor mounted	1	Floor mounted	Floor mounting bracket
Workstation Area 1- EIMD	5Hp Floor mounted	1	Floor mounted	Floor mounting bracket
Workstation Area 2- EIMD	5Hp Floor mounted	1	Floor mounted	Floor mounting bracket
ERDUD Storage	3Hp Split	1	Wall mounted	Concrete wall
EIMD Storage	3Hp Split	1	Wall mounted	Concrete wall
5th Floor				
Legal Office	3Hp Split	1	Wall mounted	Concrete wall
Book keeper	2Hp Split	1	Wall mounted	Concrete wall
COA	2Hp Split	1	Wall mounted	Concrete wall
Admin Workstation-1	5Hp Split	1	Floor mounted	Floor mounting bracket
Admin Workstation-2	5Hp Split	1	Floor mounted	Floor mounting bracket
Office of the Secretary	3Hp Split	1	Wall mounted	Concrete wall
Director	3Hp Split	1	Wall mounted	Concrete wall
Director's Guest	3Hp Split	1	Wall mounted	Concrete wall
Conference Room-1	5Hp Split	1	Floor mounted	Floor mounting bracket
Conference Room-1	5Hp Split	1	Floor mounted	Floor mounting bracket
Storage Room-Admin	3Hp Split	1	Wall mounted	Concrete wall

[illegible]

3RD FLOOR MODULAR
FURNITURES LAYOUT

JACOB A. SERA
CIVIL ENGINEER

	DEPARTMENT OF ENERGY 8001 CAMPUS SITE, CDD/CITY	PREPARED BY ENGR. SAUL S. RODRIGALES 1522 ALBERMARLE DR. MC	SHEET 1	PROPOSED RENOVATION OF DOE OFFICE	RECOMMENDING AGENCY ATTY. LEONDO J. PULIDO III ASSISTANT ATTORNEY GEN.	DATED 11/1/80	10/1/80
	REGIONAL OFFICE? CENTRAL MEXICO	LOCATION: 15TH FLOOR, BUNKER CAMPUS, SITE, CDD/CITY	DONATO D. MARCOS SUPERINTENDENT, DOE	12/1/80	8	10/1/80	10/1/80

LOCATION OF AIRCON CONDENSING UNITS.

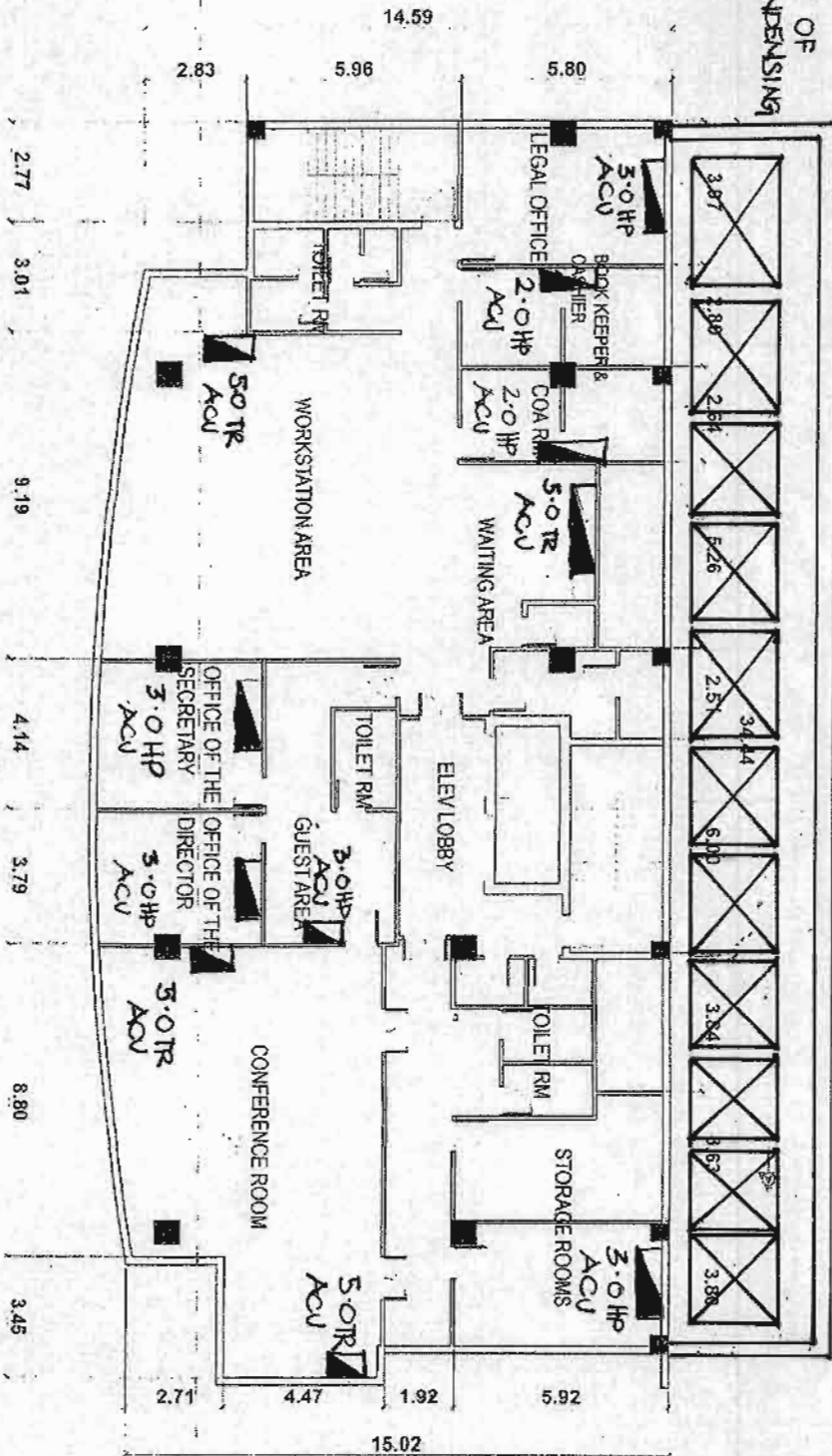

NOTE
ALL SPILT TYPE ACU
ARE ATTACHED TO THE
CONCRETE WALL.

5TH FLOOR PLAN
SCALE 1:125
MMS

WEE JERLA SERVA
CIVIL ENGINEER



DEPARTMENT OF ENERGY DRY, CAPITAL, INC. CITY	PREPARED BY ENGR. SERVA J. GONZALES 100, DIRECTOR, DGE, WFO	PROJECT PROPOSED RENOVATION OF DOE OFFICE	RECOMMENDATIONS APPROVAL ATTY. LEONARD J. PULIDO III ADMINISTRATIVE, DOE	APPROVED BY DONATO O. MARCOS ADMINISTRATIVE, DOE	REMARKS AS NOTED	DATE A. 6. 8
---	---	---	--	--	---------------------	-----------------

1. MFO PROPOSED AIR-CONDITION INSTALLATIONS

Area	Capacity/Type of ACU	No. of Units	Where to Install	Type of Material Where the Units are Fixed
3rd FLOOR				
Office areas for ERDUD, EIMD and Financial and Administrative Services	5.0 TR inverter type	4	Ceiling-mounted	Hardi-flex ceiling and using angular bars
Office of the Director	2.0 HP split type inverter	1	Wall-mounted	Concrete wall
Mini-conference Room	2.0 HP split type inverter	1	Wall-mounted	Concrete Wall
COA Office	1.5 HP split type inverter	1	Wall-mounted	To be installed in the wooden wall partition but pending office renovation the unit will be installed by using angular bars and ply boards (hanging)
Cahier's Office	2.5 HP split type inverter	1	Wall-mounted	To be installed in the wooden wall partition but pending office renovation the unit will be installed by using angular bars and ply boards (hanging)
4th FLOOR				
Conference Room	5.0 TR inverter type	1	Ceiling-mounted	Hardi-flex ceiling and using angular bars
Lounge Area	3.0 HP split type inverter	1	Wall-Mounted	To be installed in the wooden wall partition but pending office renovation the unit will be installed by using angular bars and ply boards (hanging)
EO Room	2.0 HP split type inverter	1	Wall-mounted	Concrete Wall
Staff Area	2.0 HP split type inverter	1	Wall-mounted	To be installed in the wooden wall partition but pending office renovation the unit will be installed by using angular bars and ply boards (hanging)
Command Center	2.0 HP split type inverter	1	Wall-mounted	To be installed in the wooden wall partition but pending office renovation the unit will be installed by using angular bars and ply boards (hanging)
EO Secretary Area	2.0 HP split type inverter	1	Wall-mounted	To be installed in the wooden wall partition but pending office renovation the unit will be installed by using angular bars and ply boards (hanging)

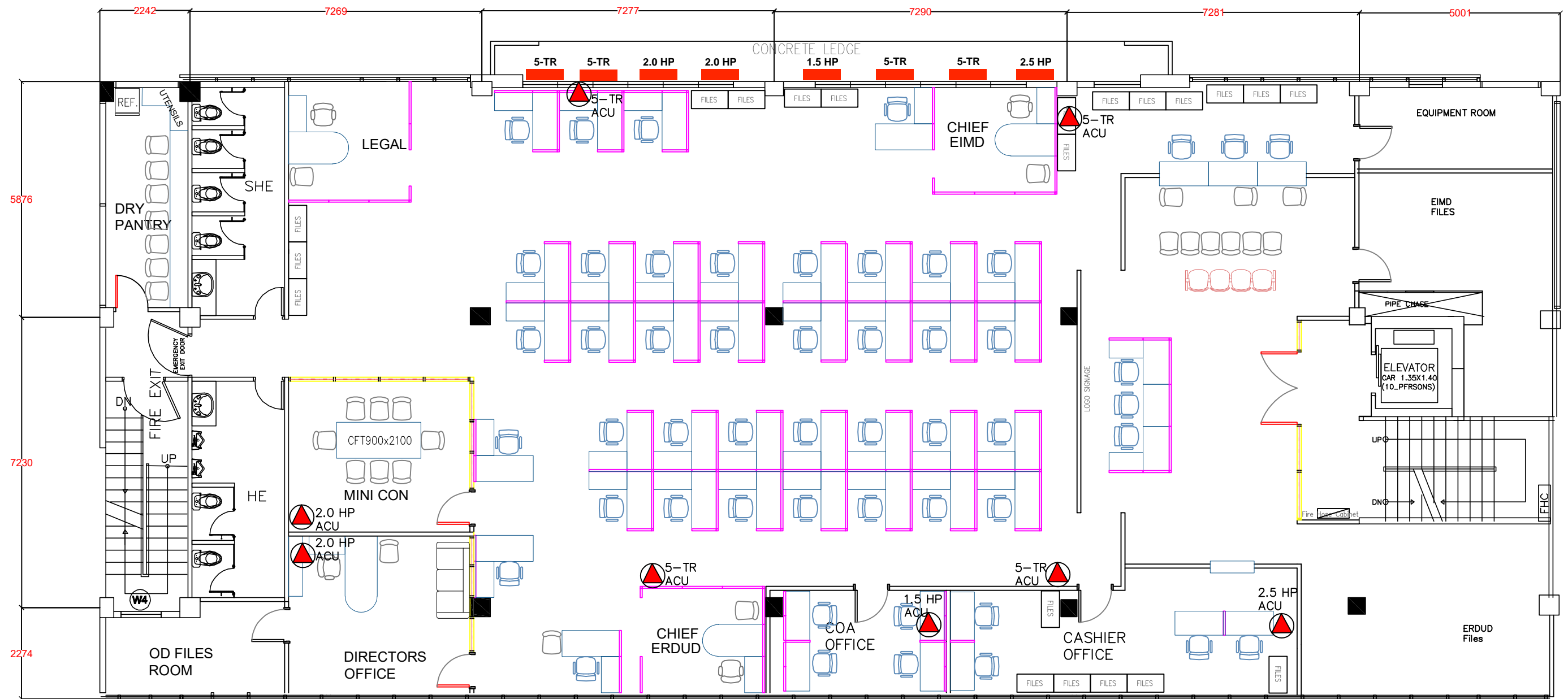

MFO Proposed Office Layout 3

3rd Floor

Prepared by:

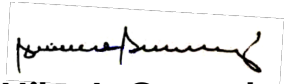
Nilo J. Geroche
Director, MFO

Concurred by:

Jericho O. Bragado
Chief, GSD

Endorsed by:

Pacifico A. Avenido, Jr.
OIC—Director, AS

Approved by:

Robert B. Uy
OIC—Undersecretary

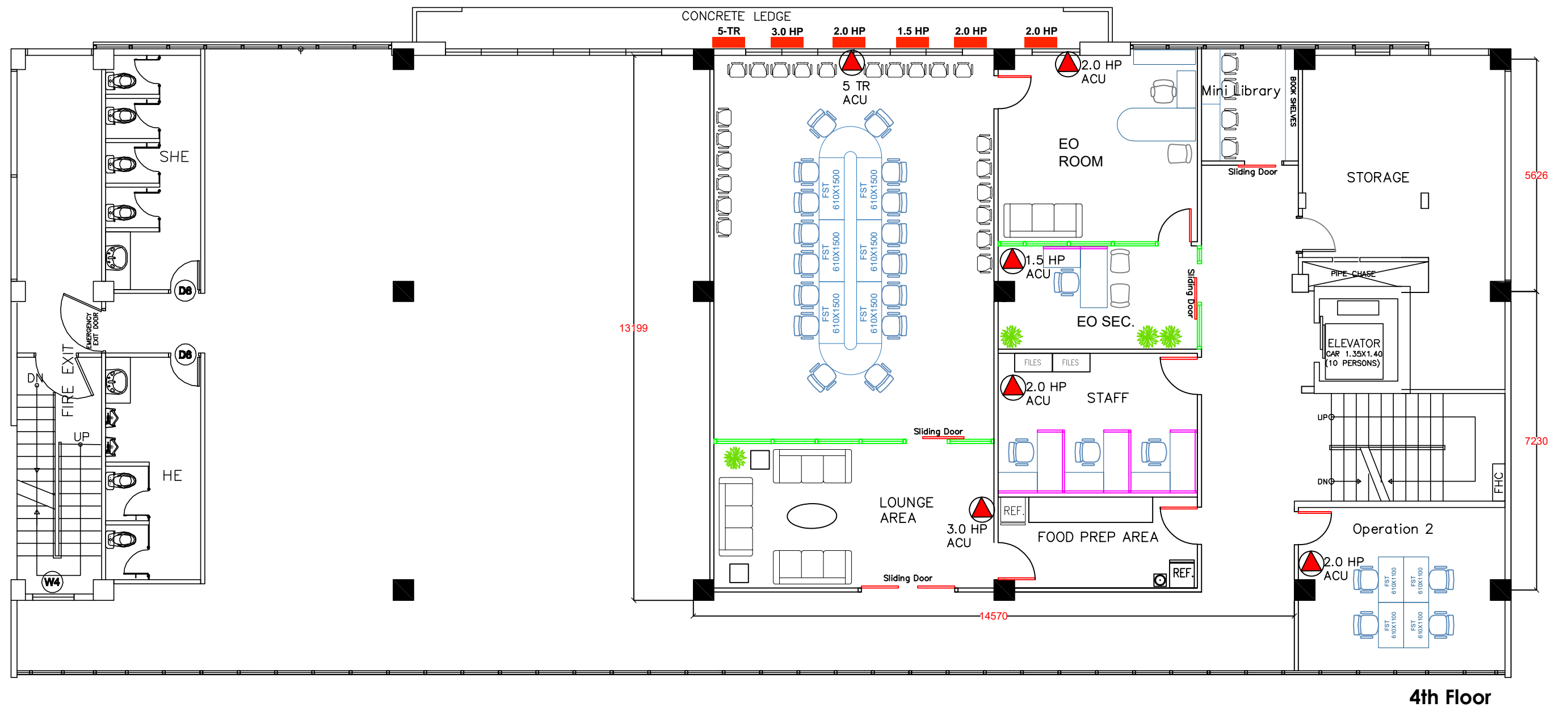

4th Floor

Prepared by:

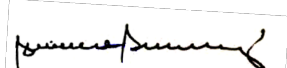
Nilo J. Geroche
Director, MFO

Concurred by:

Jericho O. Bragado
Chief, GSD

Endorsed by:

Pacifico A. Avenido, Jr.
OIC—Director, AS

Approved by:

Robert B. Uy
OIC—Undersecretary

1. MFO PROPOSED AIR-CONDITION INSTALLATIONS

Area	Capacity/Type of ACU	No. of Units	Where to Install	Type of Material Where the Units are Fixed
3rd FLOOR				
Office areas for ERDUD, EIMD and Financial and Administrative Services	5.0 TR inverter type	4	Ceiling-mounted	Hardi-flex ceiling and using angular bars
Office of the Director	2.0 HP split type inverter	1	Wall-mounted	Concrete wall
Mini-conference Room	2.0 HP split type inverter	1	Wall-mounted	Concrete Wall
COA Office	1.5 HP split type inverter	1	Wall-mounted	To be installed in the wooden wall partition but pending office renovation the unit will be installed by using angular bars and ply boards (hanging)
Cahier's Office	2.5 HP split type inverter	1	Wall-mounted	To be installed in the wooden wall partition but pending office renovation the unit will be installed by using angular bars and ply boards (hanging)
4th FLOOR				
Conference Room	5.0 TR inverter type	1	Ceiling-mounted	Hardi-flex ceiling and using angular bars
Lounge Area	3.0 HP split type inverter	1	Wall-Mounted	To be installed in the wooden wall partition but pending office renovation the unit will be installed by using angular bars and ply boards (hanging)
EO Room	2.0 HP split type inverter	1	Wall-mounted	Concrete Wall
Staff Area	2.0 HP split type inverter	1	Wall-mounted	To be installed in the wooden wall partition but pending office renovation the unit will be installed by using angular bars and ply boards (hanging)
Command Center	2.0 HP split type inverter	1	Wall-mounted	To be installed in the wooden wall partition but pending office renovation the unit will be installed by using angular bars and ply boards (hanging)
EO Secretary Area	2.0 HP split type inverter	1	Wall-mounted	To be installed in the wooden wall partition but pending office renovation the unit will be installed by using angular bars and ply boards (hanging)

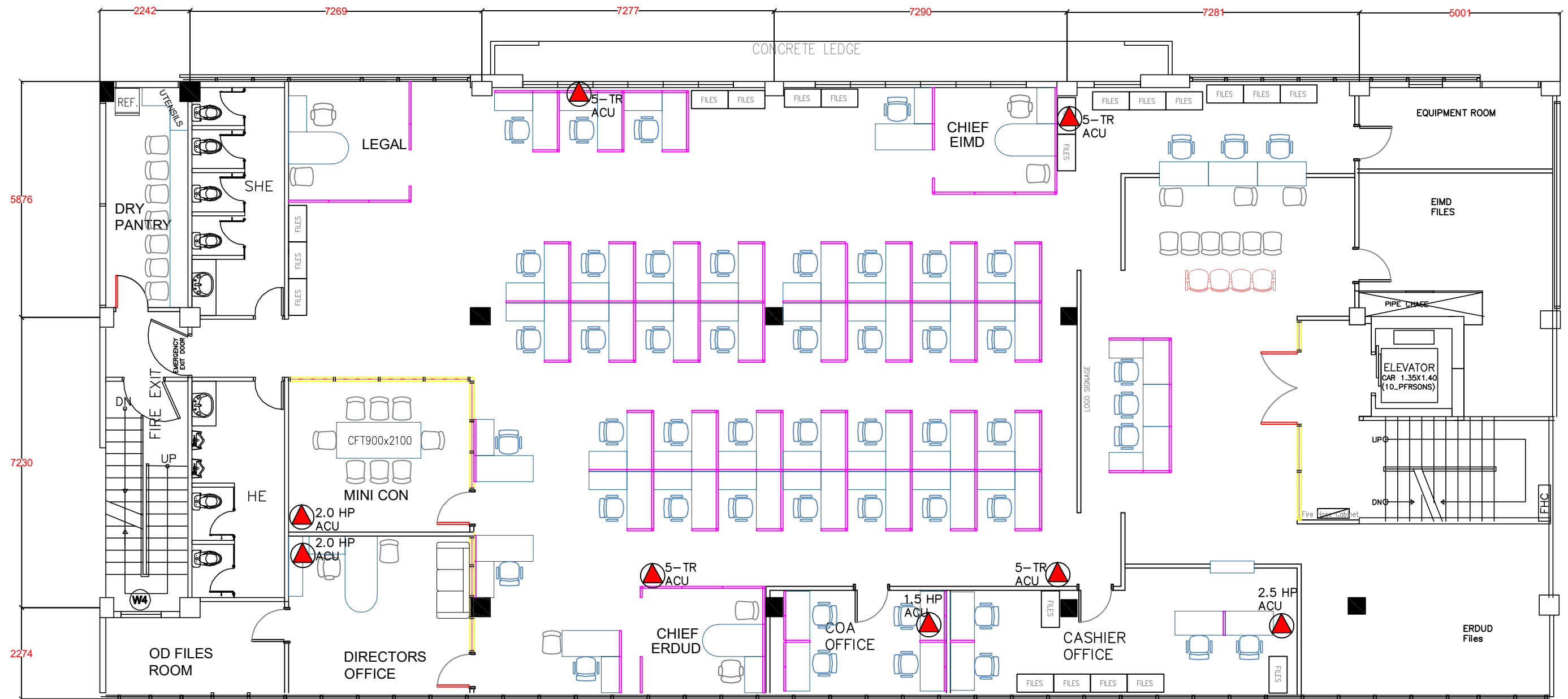

MFO Proposed Office Layout 3

3rd Floor

Prepared by:

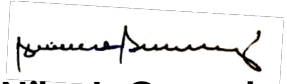
Nilo J. Geroche
Director, MFO

Concurred by:

Jericho O. Bragado
Chief, GSD

Endorsed by:

Pacifico A. Avenido, Jr.
OIC-Director, AS

Approved by:

Robert B. Uy
OIC-Undersecretary

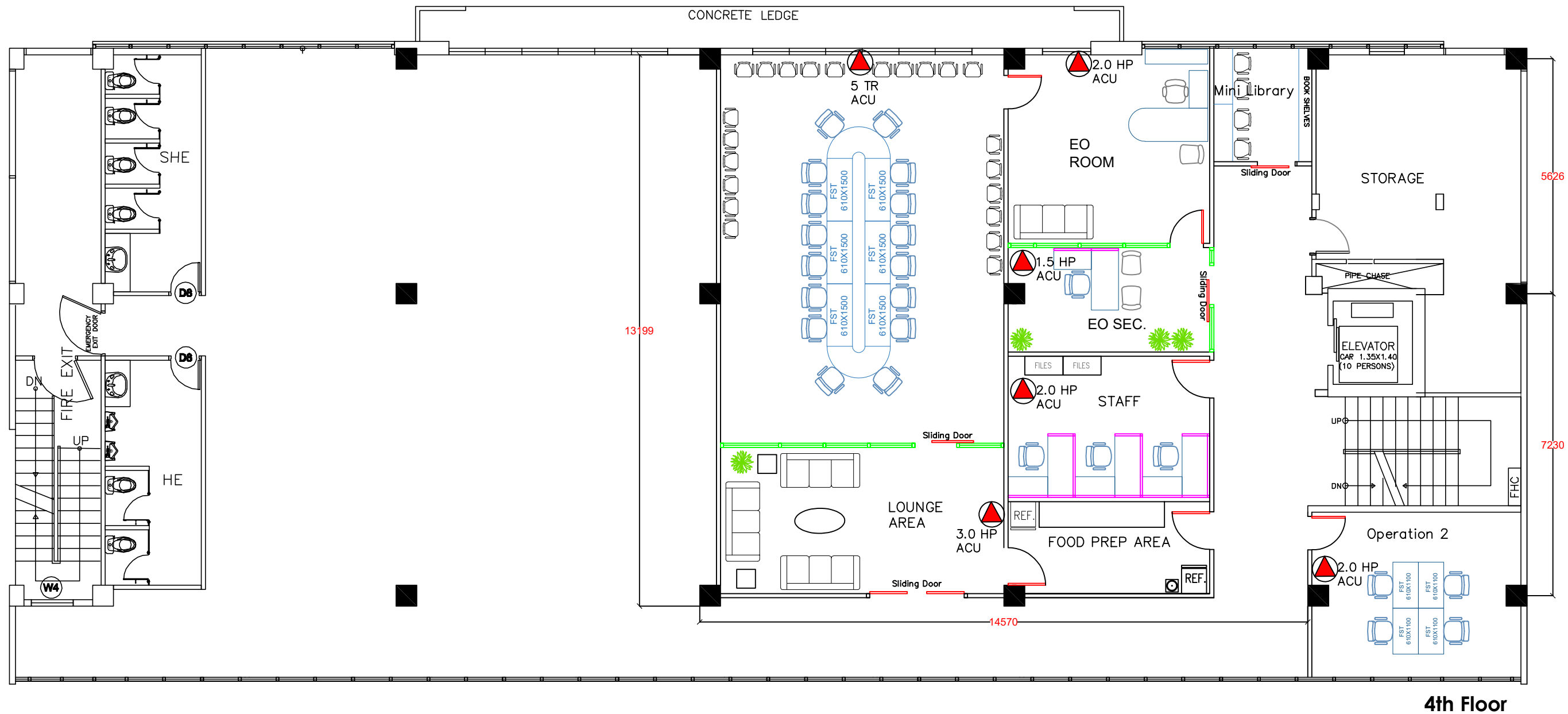

4th Floor

Prepared by:

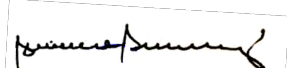
Nilo J. Geroche
Director, MFO

Concurred by:

Jericho O. Bragado
Chief, GSD

Endorsed by:

Pacifico A. Avenido, Jr.
OIC—Director, AS

Approved by:

Robert B. Uy
OIC—Undersecretary

2. COMPLETE ADDRESS OF THE OFFICE

DEPARTMENT OF ENERGY – MINDANAO FIELD OFFICE

3. FOCAL PERSON

Principal Focal Person

ENGR. NILO J. GEROCHÉ
Director, DOE-MFO

Alternate Focal Person

ENGR. ERNESTO P. OBELIDHON
Chief SRS, DOE-MFO-ERDUD

Field Office	Address	Focal Person, Principal	Focal Person, Alternate
Luzon Field Office	Pangasinan – Nueva Viscaya Rd., Purok 6, Brgy. Carmay East, Rosales, Pangasinan	Engr. Renante Sevilla Director	Engr. Julius Caesar G. Pantaleon
Visayas Field Office	5 th Floor, Escario Bldg., 731 Escario Street., Old Capitol, Cebu City	Maria Farrah M. Montebon	Miguel N. Trenuela Robert James O. Lacandazo
Mindanao Field Office	3 rd & 4 th Floor, Tolentino 2020 Building, Candelaria Ave., Ecoland, Matina, Davao City	Engr. Nilo J. Geroche Director	Engr. Ernesto P. Obelidhon Chief SRS□ERDUD